

# CAPACITY CHART AT THE ART HOTEL



## MEETING ROOM CAPACITY

Room Name	Width	Length	Square Feet	Boardroom	Classroom	Theater	Banquet	Reception	Conference	U Shape
Broadway Ballroom	85	37	3,145	100	169	290	200	350	128	101
Ballroom South	28	37	1,036	40	50	80	60	118	25	30
Ballroom Central	29	37	1,073	40	50	80	60	122	30	35
Ballroom North	28	37	1,036	40	50	80	60	118	25	30
Allessandro's Room	18	11.5	207	10	12	20	-	-	-	-
Ruff & Tumble Room	15	24	360	12	16	25	20	-	-	-
Opposing Forces Room	16	28	448	14	-	-	-	20	14	-
FIRE Terrace	-	-	1,905	-	-	-	48	100	-	-
Portico Gallery	-	-	1,575	-	-	75	50	100	-	-

## FIRE DINING & LOUNGE CAPACITIES

Fire Restaurant	86
Fire Lounge	40
Fire Terrace	50
Bear Den	20
Bottom's Up Room	6

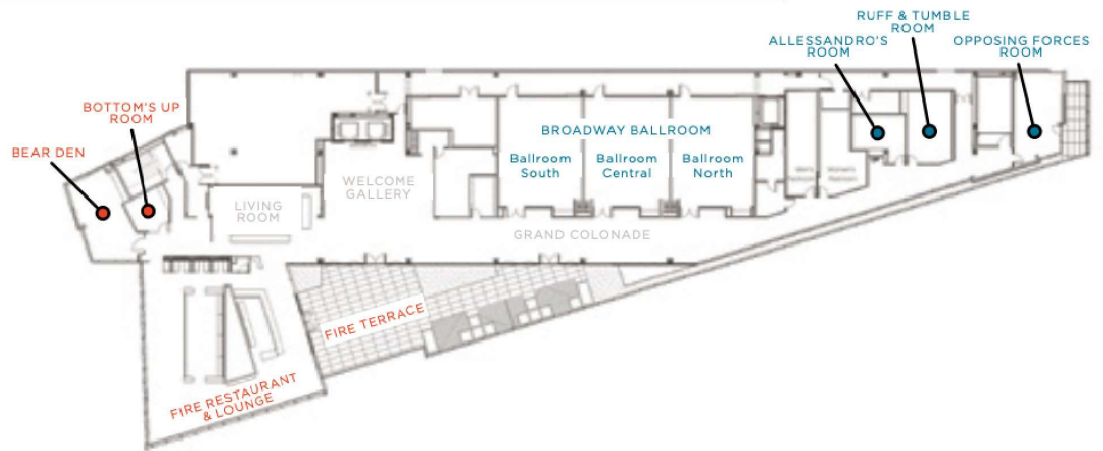

# VENUE SET UP FEES/F&B MINIMUMS AT THE ART HOTEL

Function Room	Room Rental	F&B Minimum	Notes
Bear Den	\$500	\$1,500 - \$2,000	
Bottoms Up	\$250	Waived	
Living Room	\$500 - \$750	\$2,000	*Higher room rental for significant furniture shift
FIRE Restaurant (dining room)	\$2,000	\$8,000	
Full FIRE Buyout	\$5,000	\$10,000	*Requires approval from GM, DOSM
FIRE Cabanas	\$500 Each	\$500 Each	
Main FIRE Terrace	\$2,000- \$3,000	\$5,000 - \$7,500	*Higher room rental for significant furniture shift
Full FIRE Terrace	\$3,000 - \$4,000	\$10,000	*Higher room rental for significant furniture shift and requires approval from GM, DOSM
Grand Colonnade	\$750	\$2,500 - \$3000	
Broadway Ballroom	\$3,000	\$10,000 - \$18,000	
Broadway North	\$1,000	\$3,000 - \$6,000	
Broadway Central	\$1,000	\$3,000 - \$6,000	
Broadway South	\$1,000	\$3,000 - \$6,000	
Alessandro	\$500	\$750	
Ruff & Tumble	\$500	\$1,000	
Opposing Forces	\$1,000	\$1,500	
Portico Gallery	\$750.00	\$2,500 - \$3,000	

\*FIRE Bar may never be bought out for private events.

\*During FIRE Restaurant buyouts, Living Room or Bear Den must be unsold, left available for hotel guest dining.