



NATIONAL
MEDAL *of* HONOR
MUSEUM



EVENT VENUES

WELCOME

Experience the exceptional when you book your event at the National Medal of Honor Museum. Situated in the heart of Arlington, TX, our museum offers a collection of captivating event spaces suitable for your next gathering. Whether you're planning a board meeting or a black-tie affair, the National Medal of Honor Museum has the right space for you.

Conveniently located in Arlington's Entertainment District, the museum is within walking distance from the brand-new Loews Arlington Hotel, Live! by Loews, Texas Live!, AT&T Stadium, and Globe Life Field.

Let's partner together to create an exceptional event experience from beginning to end.

COURAGE & SACRIFICE | COMMITMENT & INTEGRITY | CITIZENSHIP & PATRIOTISM

ROTUNDA OF HONOR

The Rotunda of Honor is the Museum's premier event space for hosting ceremonies, banquets, cocktail receptions, and more. Adorned with a radiant ring showcasing the names of each Medal of Honor recipient, the 5,600 sq. ft. open-air Rotunda embodies the spirit of excellence and elegance.

The Rotunda provides a dignified setting for ceremonies and special events. Whether commemorating significant milestones, honoring community leaders, or celebrating corporate achievements, the Rotunda of Honor offers a sophisticated backdrop for your most cherished events.

VENUE CAPACITIES

SQUARE FOOTAGE	5,600
RECEPTION	500
BANQUET	240
THEATER	300
VENUE FEE	\$7,500
F&B MINIMUM	\$10,000

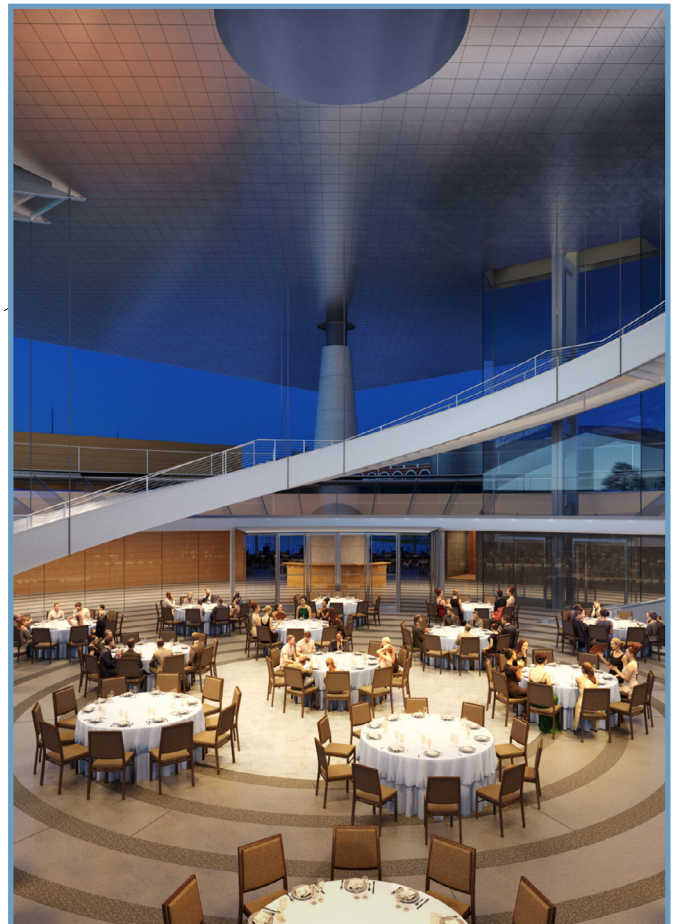
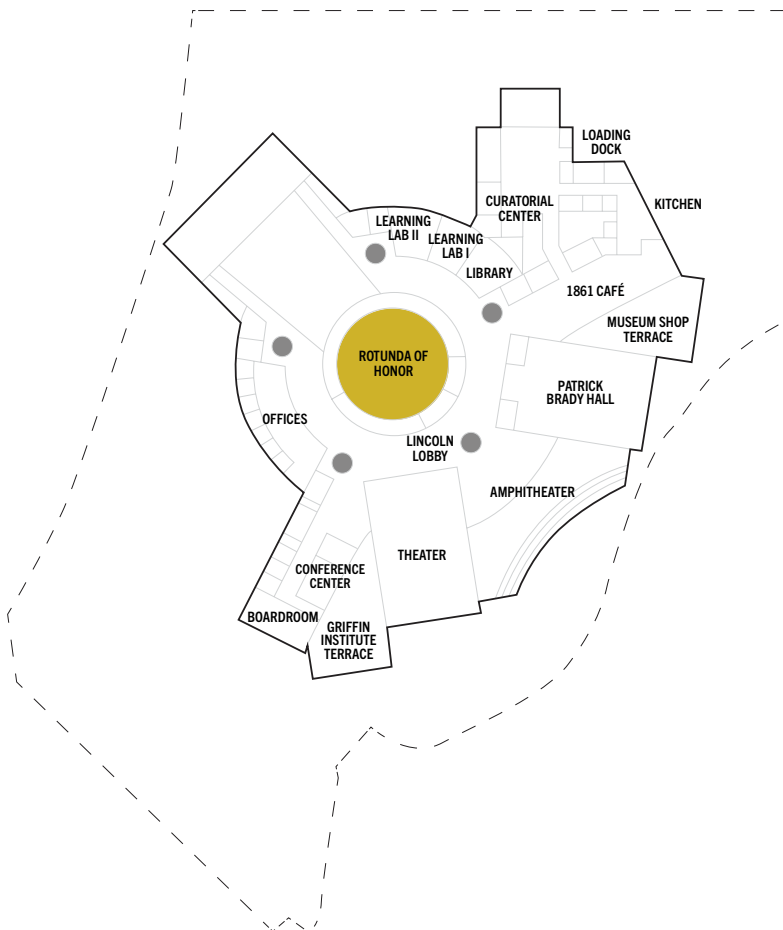

PATRICK BRADY HALL

GENE & JERRY JONES FAMILY

Welcome to the Great Hall, where grandeur meets versatility in our Museum's Patrick Brady Hall.

With 4,300 sq. ft. and soaring ceilings reaching 22 feet high, the Patrick Brady Hall commands attention from the moment you step inside. The scenic backdrop view of Mark Holtz Lake sets the stage for unforgettable moments, making the Patrick Brady Hall a coveted destination for gatherings of all kinds.

From elegant receptions and galas to dynamic exhibitions, this versatile space seamlessly adapts to your unique vision.

VENUE CAPACITIES

SQUARE FOOTAGE	4,300
RECEPTION	350
BANQUET	200
THEATER	300
CLASSROOM	150
VENUE FEE	\$6,000
F&B MINIMUM	\$7,500

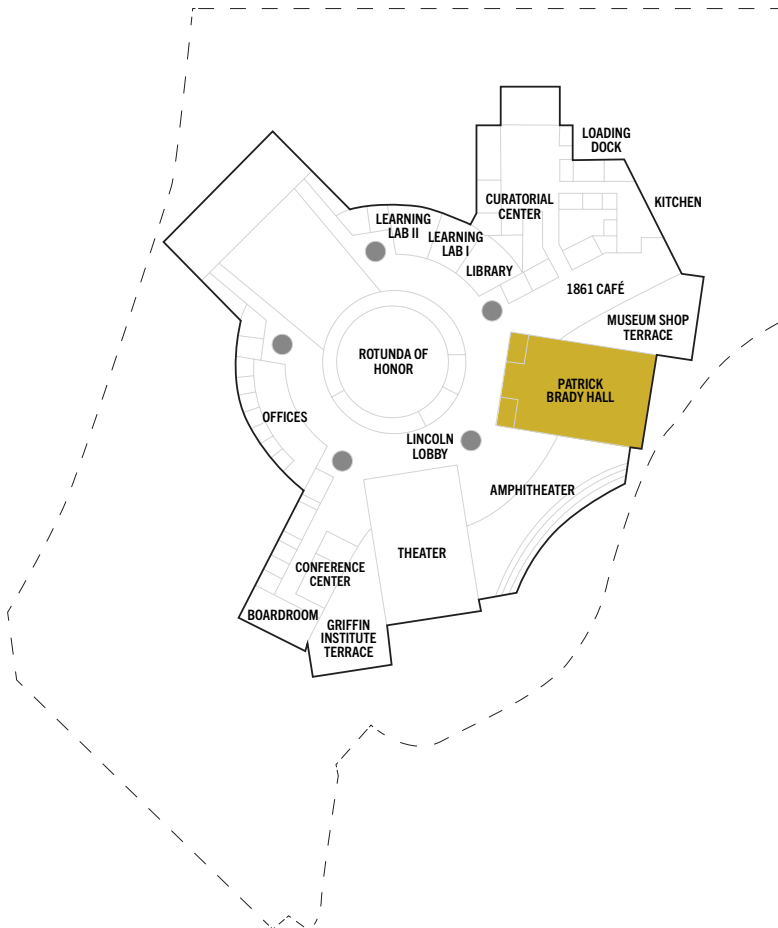

LINCOLN LOBBY

DAWN & IAN AARON

Step into the Lincoln Lobby, where intimacy meets panoramic brilliance. The glass-enclosed 10,500 sq. ft. space offers views of the Amphitheater and serene Mark Holtz Lake.

Serving as the central hub of the Museum and flanked by the Patrick Brady Hall and the Kearby Theater, the Lincoln Lobby is the perfect location to host a cocktail reception with a unique blend of intimacy and energy.

Whether hosting a private reception, a corporate meeting, or a formal dinner, the Lincoln Lobby offers adaptability and sophistication for your one-of-a-kind event.

VENUE CAPACITIES

SQUARE FOOTAGE	10,500
RECEPTION	600
BANQUET	400
VENUE FEE	\$6,000
F&B MINIMUM	\$5,000

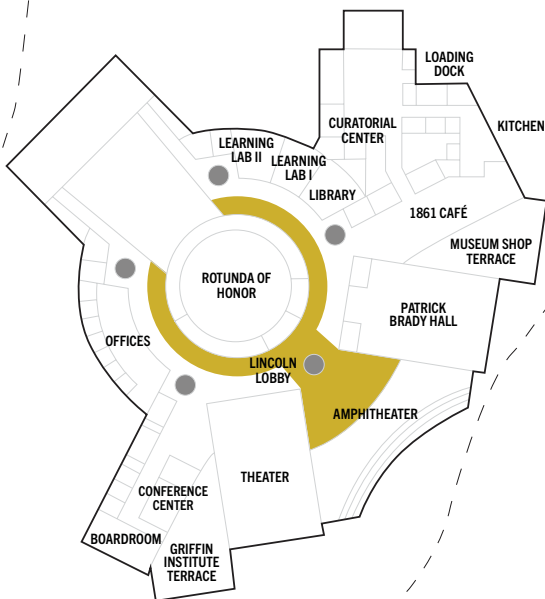

NEEL KEARBY THEATER

ARLINGTON TOMORROW FOUNDATION & CITY OF ARLINGTON

The Col. Neel E. Kearby Theater is the programming centerpiece of the Museum.

As an essential space supporting the Museum's educational and leadership programs, the Theater will be host to world-class speaking engagements, seminars, and workshops. The Neel Kearby Theater features 233 fixed seats, 6 ADA seats, a 1,000-square-foot stage, and state-of-the-art technology to support the broadcast needs of on-site, local, and national media coverage for its preeminent events and programs.

VENUE CAPACITIES

SQUARE FOOTAGE	3,110
THEATER	239
VENUE FEE	\$7,500

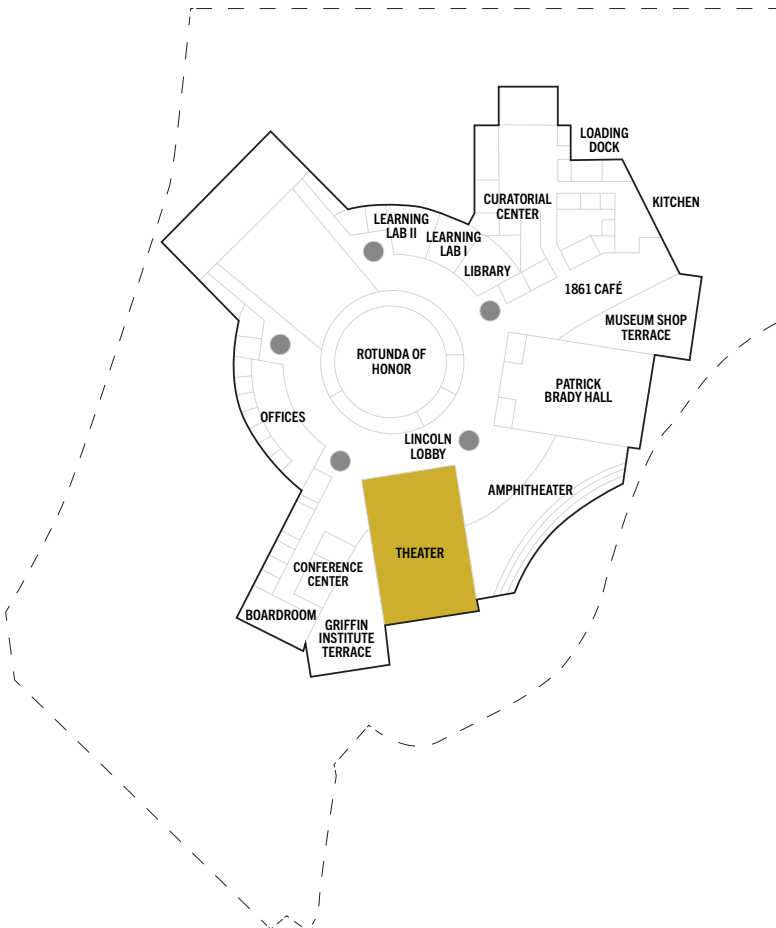

GRIFFIN INSTITUTE BOARDROOM

VOLHA & NICHOLAS SINGE

Situated within the Griffin Institute, the Griffin Institute Boardroom is a preferred location in Arlington for high-level meetings and conferences.

The Griffin Institute Boardroom is professionally designed with polished panel walls and a 26-seat meeting table, with direct access to smaller breakout rooms. The 1,300 sq. ft. meeting space has premier audiovisual equipment and global connectivity for national and international summits.

Our designated catering and event coordination staff will ensure an enjoyable and seamless planning experience from start to finish.

VENUE CAPACITIES

CLASSROOM	26
SQUARE FOOTAGE	1,300
VENUE FEE	\$2,000
F&B MINIMUM	\$3,000

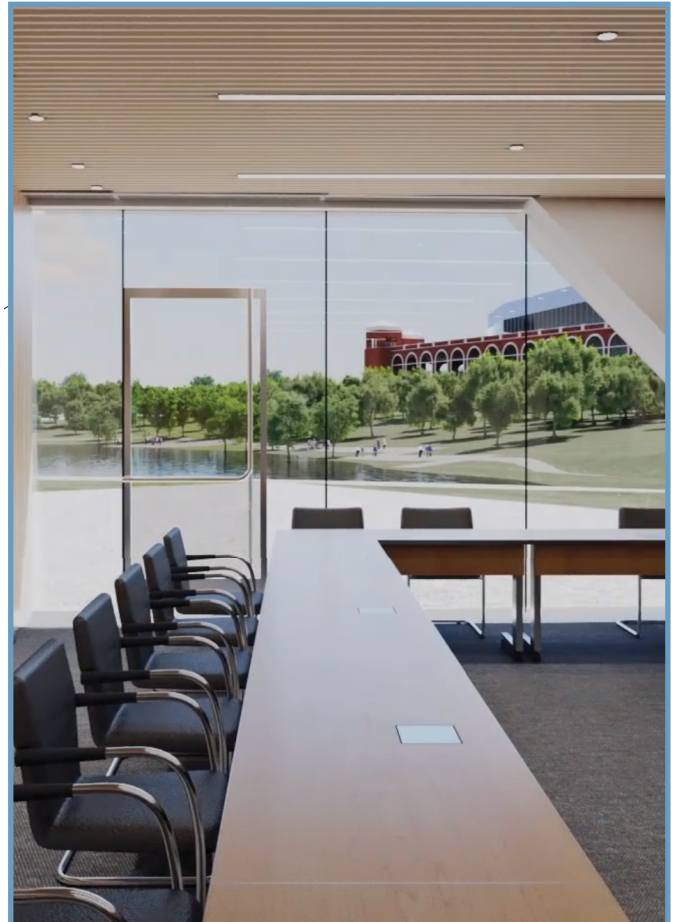
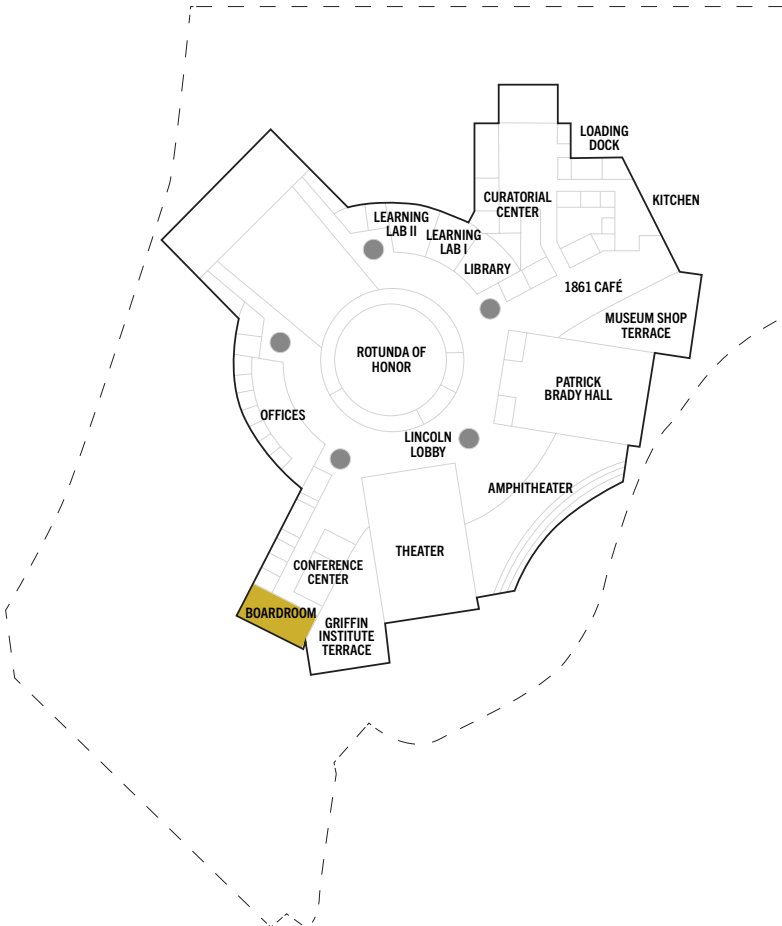

CONFERENCE CENTER

AMERICAN AIRLINES

Our state-of-the-art Conference Center is where sophistication meets functionality.

Located within the heart of the Griffin Institute, the Conference Center offers quick access to the Griffin Institute Boardroom and private restrooms.

Whether you're hosting a corporate training session, a seminar, or a school program, our Conference Center is flexible and functional to suit your specific needs.

VENUE CAPACITIES

SQUARE FOOTAGE	1,200
RECEPTION	100
BANQUET	60
THEATER	80
CLASSROOM	30
HOLLOW SQUARE	20
VENUE FEE	\$2,000
F&B MINIMUM	\$4,000

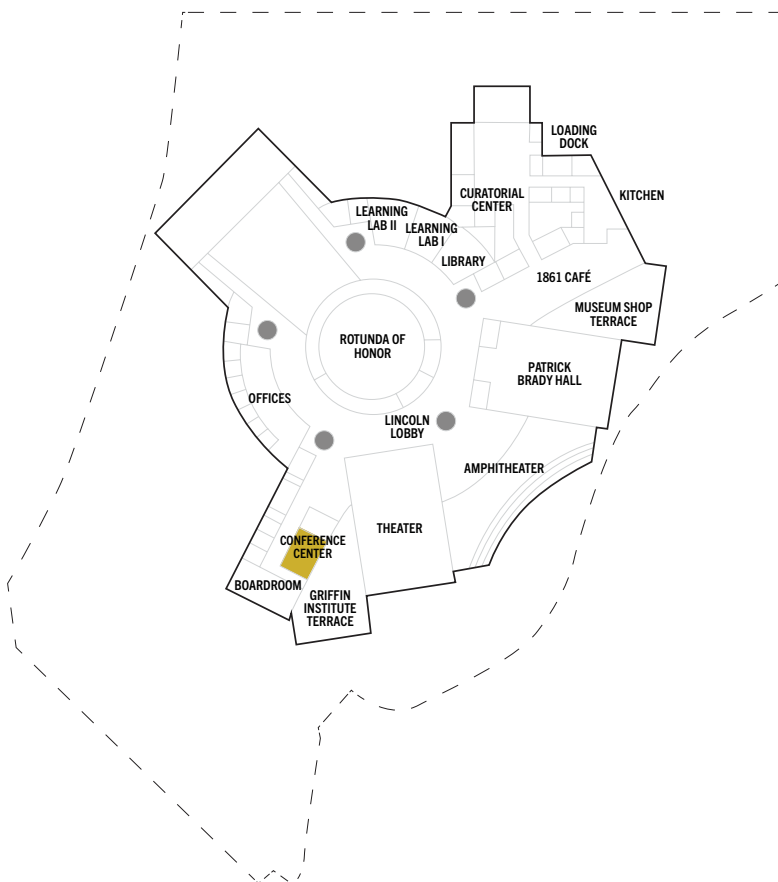

GRIFFIN INSTITUTE TERRACE

Our Griffin Institute Terrace is situated just beyond the Griffin Institute and overlooks Mark Holtz Lake.

From intimate gatherings to spectacular celebrations of up to 160 guests, our Griffin Institute Terrace and Terrace Lobby can be customized to suit your every need. The hybrid space allows guests to seamlessly transition between our indoor lobby space and the spacious outdoor terrace.

The Terrace Lobby features a built-in counter height bar, ideal for hosting cocktail hours and social events. The Terrace offers flexible furniture arrangements, ambient lighting, and access to museum amenities.

VENUE CAPACITIES

SQUARE FOOTAGE	3,600
RECEPTION	150
BANQUET	120
VENUE FEE	\$5,000
F&B MINIMUM	\$5,000

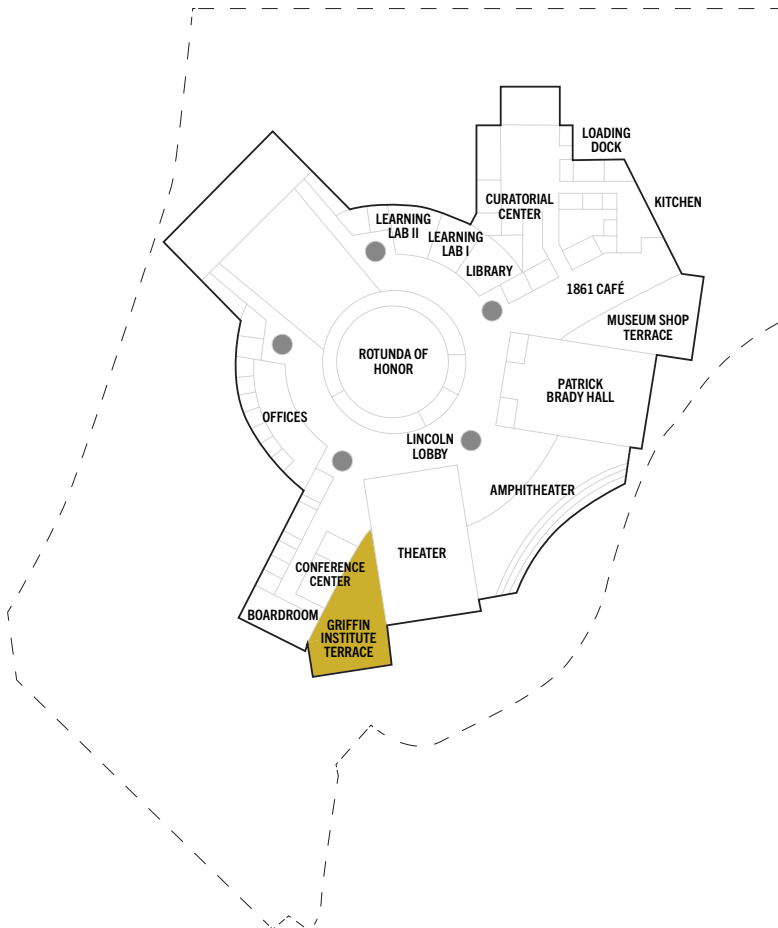

AMPHITHEATER

LOEWS HOTELS & CO

The Amphitheater at the National Medal of Honor Museum is located just outside of the Museum and intertwined with the beautifully landscaped grounds overlooking Mark Holtz Lake. The 3,300 sq. ft. Amphitheater is a distinguished venue offering a wide variety of event opportunities.

From fireworks displays, drone shows, and concerts to dinners and receptions, the Amphitheater is situated as a premier outdoor event space in Arlington.

VENUE CAPACITIES

SQUARE FOOTAGE	3,300
RECEPTION	250
THEATER	200
VENUE FEE	\$6,000
F&B MINIMUM	\$7,500

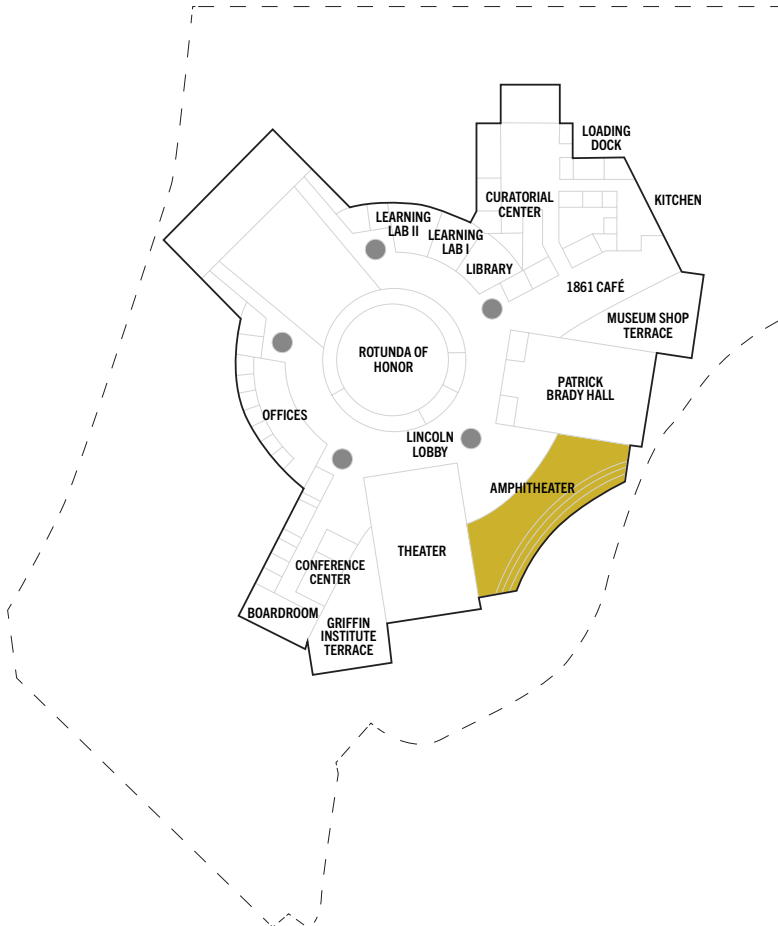

EXHIBIT DECK: MAIN GALLERY

Located within a steel-clad space held aloft by five pillars, the Exhibition Galleries stand as the museum's crowning jewel, captivating visitors with immersive narratives that honor the valor and sacrifice of our nation's heroes.

The elevated acre of exhibition space includes cutting edge exhibits, authentic artifacts, impactful media presentations, and engaging digital interactives. History comes alive as you immerse yourself into the heroic stories of those who have earned our nation's highest honor.

An event in our Exhibit Deck promises an unparalleled experience, allowing you and your guests exclusive access to explore every facet of this iconic museum at your own pace. Whether you're hosting a corporate reception, a gala fundraiser, or a private celebration, the National Medal of Honor Museum offers a unique backdrop for events that honor the past, celebrate the present, and inspire the future.

VENUE CAPACITIES

SQUARE FOOTAGE	40,000
RECEPTION	500



LEARNING LAB I

ANNETTE SIMMONS

Explore inspiring spaces by renting one of our museum classrooms. Nestled within the Museum's first floor, our two classrooms offer an inspiring setting for meetings and teachings.

Equipped with modern amenities and technology, our classrooms provide everything you need to ensure a seamless and successful event.

VENUE CAPACITIES

SQUARE FOOTAGE	800
RECEPTION	40
BANQUET	32
THEATER	50
CLASSROOM	32
HOLLOW SQUARE	16
VENUE FEE	\$1,500
F&B MINIMUM	\$1,500

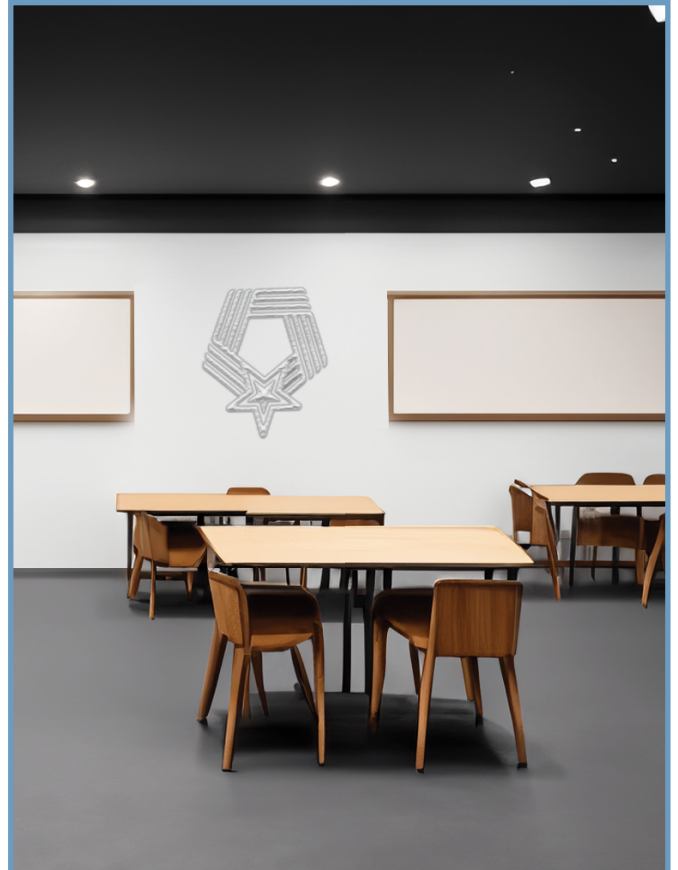
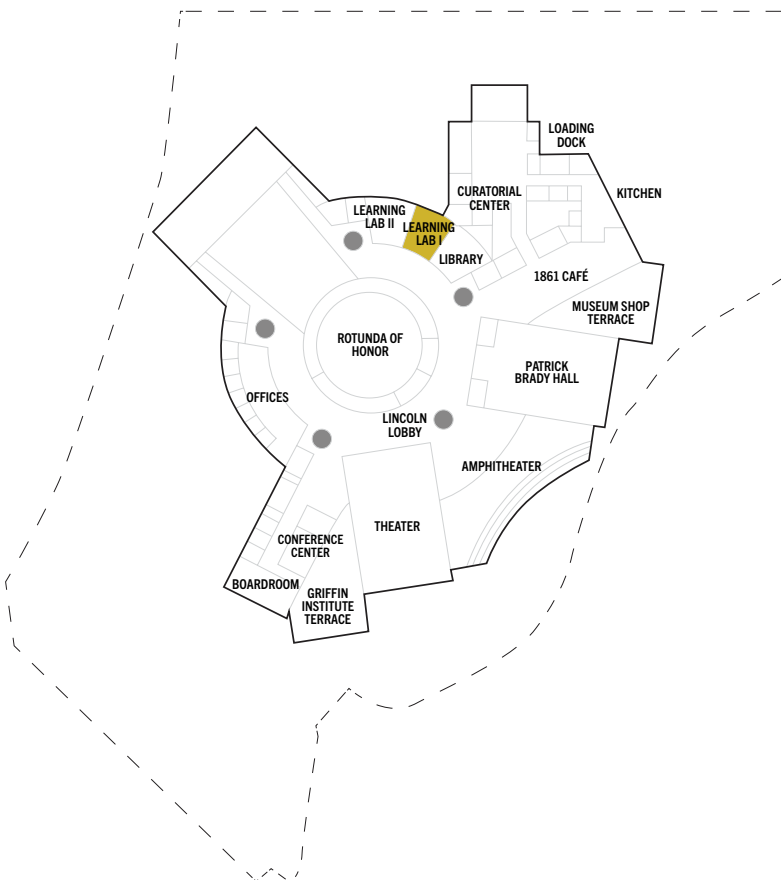

LEARNING LAB II

TARGET

Explore inspiring spaces by renting one of our museum classrooms. Nestled within the Museum's first floor, our two classrooms offer an inspiring setting for meetings and teachings.

Equipped with modern amenities and technology, our classrooms provide everything you need to ensure a seamless and successful event. From audio-visual equipment to high-speed Wi-Fi, we have you covered, allowing you to focus on delivering a memorable experience for your guests.

VENUE CAPACITIES

SQUARE FOOTAGE	800
RECEPTION	40
BANQUET	32
THEATER	50
CLASSROOM	32
HOLLOW SQUARE	16
VENUE FEE	\$1,500
F&B MINIMUM	\$1,500

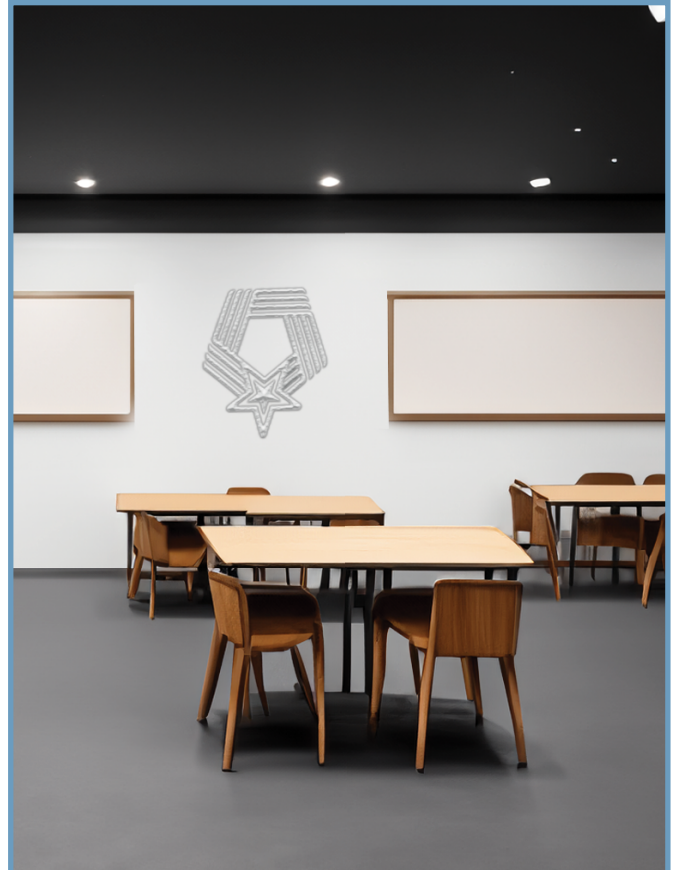
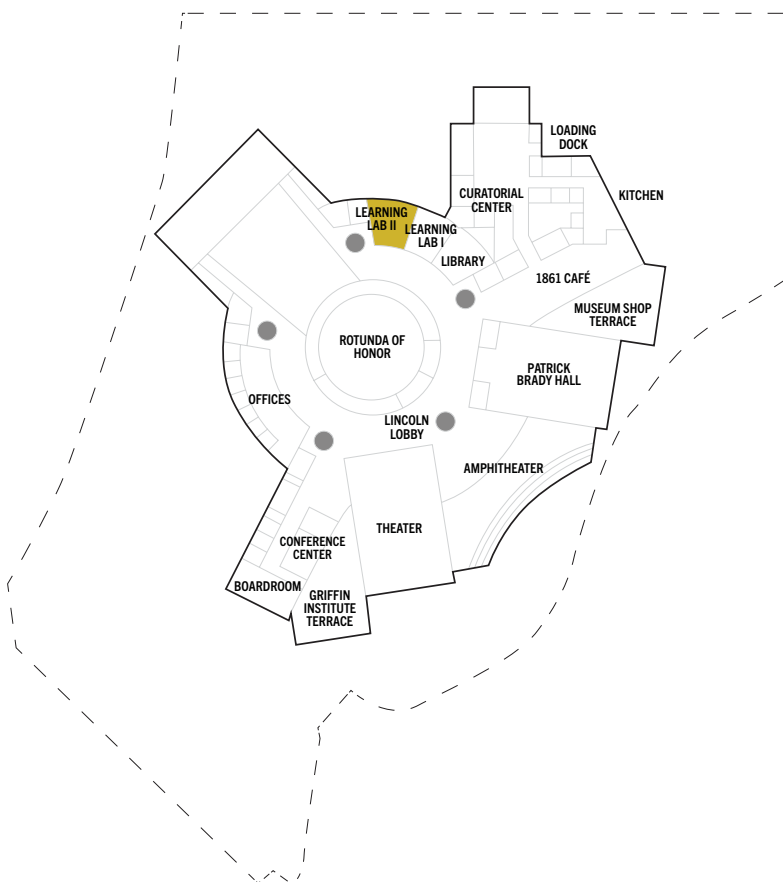

LIBRARY & ARCHIVES

SHEILA & WALTER UMPHREY

Step into our Library & Archives where you are invited to immerse yourself in an intimate experience of Medal of Honor literature and artifacts. The library holds up to 12 people, providing space for solitary studying or a small group gathering. The layout is thoughtfully designed and offers soft seating and high-top seating options.

Adding to the allure of our library are special rotating displays of Medal of Honor artifacts, each offering a poignant glimpse into the bravery and sacrifice of those who have served their country with valor.

VENUE CAPACITIES

SQUARE FOOTAGE	750
VENUE FEE	\$1,500
F&B MINIMUM	\$1,500

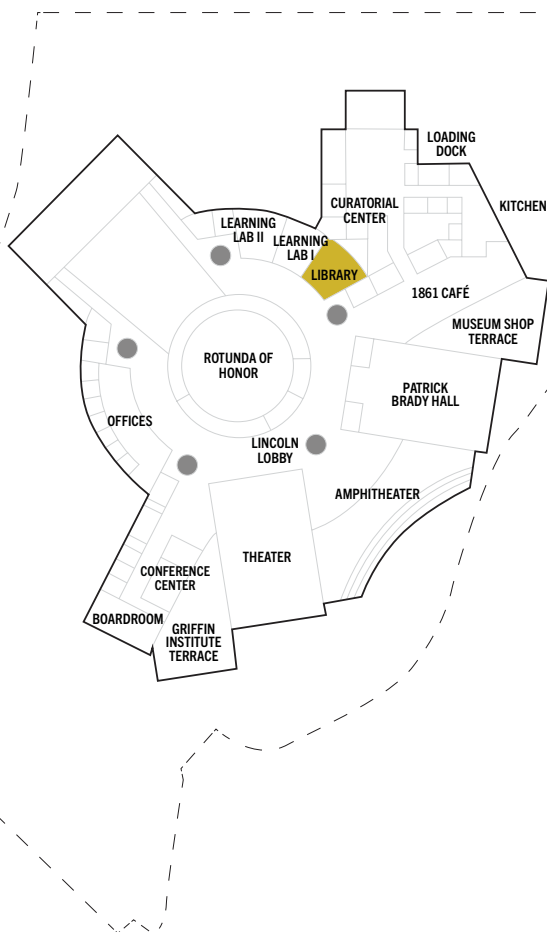

MUSEUM SHOP TERRACE

The hearts of Patriots behold stunning views at our 1861 Café and Museum Shop Terrace. Settled just north of Mark Holtz Lake and Arlington's bustling Entertainment District, this 3,600 sq. ft. versatile space offers a serene atmosphere and an exquisite view of Patriots Point.

Whether you're planning a modest celebration or a grand gathering, this space has the versatility to accommodate you and your guests. From engagement festivities and rehearsal dinners to corporate dinners and networking events, this venue is the perfect setting for many occasions.

VENUE CAPACITIES

SQUARE FOOTAGE	3,600
RECEPTION	150
BANQUET	120
VENUE FEE	\$5,000
F&B MINIMUM	\$5,000

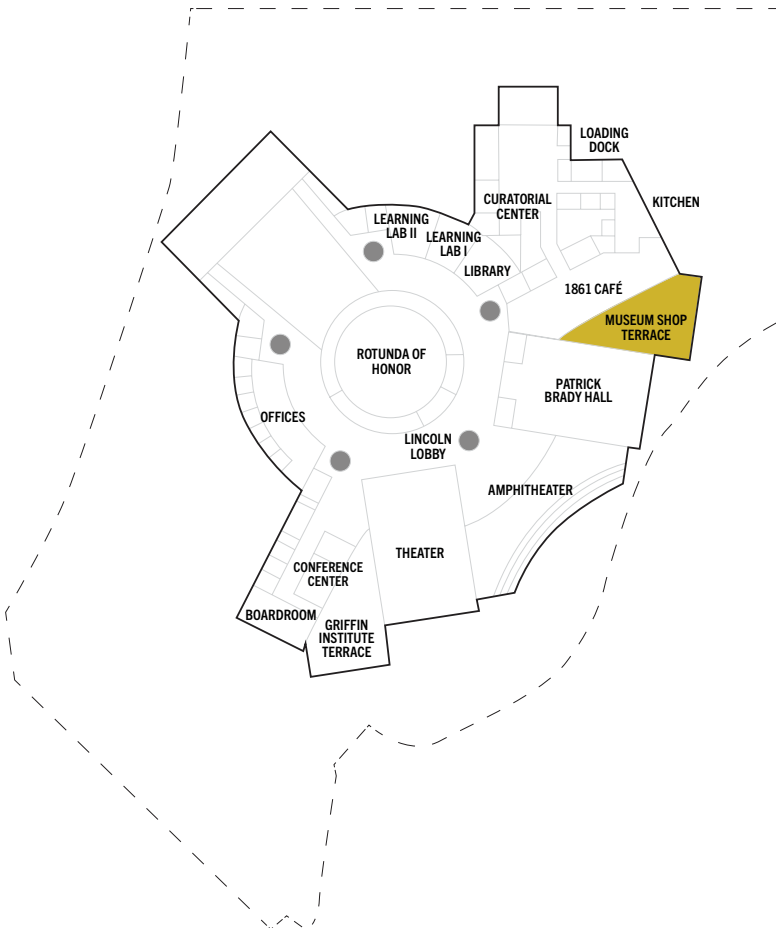



NATIONAL MEDAL *of* HONOR MUSEUM



MOHMUSEUM.ORG

1861 AT&T Way,
Arlington, TX 76011

*Legends Global Attractions is the exclusive catering
provider for the National Medal of Honor Museum.
We are proud to deliver world-class cuisine and top-tier
service that will ensure your event's success.*

[View Catering Menu](#)

[View Event
Enhancements](#)

[View Know Before You Go
Information Packet](#)

[View 360° Photos](#)



COURAGE & SACRIFICE | COMMITMENT & INTEGRITY | CITIZENSHIP & PATRIOTISM